

How to use Flixonase Nasule Drops

Always use Flixonase Nasule Drops exactly as your doctor has told you to. Don't exceed the recommended dose.

Check with your doctor or pharmacist if you're not sure.

- Do not use in children or young people under 16 years old.
- Only use in your nose, contact with the eyes should be avoided.
- It may take a few weeks for this medicine to work. So keep using it, even though you may not feel better straight away.
- You should use Flixonase Nasule Drops every day.

How much to use - adults (over 16 years of age)

- The usual starting dose is one single-use plastic container (400 micrograms) divided equally between each nostril, once or twice a day.
- As your symptoms improve, your doctor may ask you to use a lower dose.
- If your symptoms do not improve after 4 to 6 weeks your doctor may change your medicine.

What the plastic container looks like

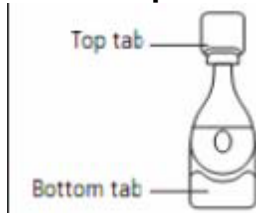

Using your Flixonase Nasule drops

1. Open the foil pack by tearing off one side. Do not open the pack until the drops are needed.
2. Take out the strip of plastic containers from the foil and pull off one container.
3. Put the remaining containers back into the foil pack and put the pack back in the box.
4. Flick and shake the plastic container several times. The contents of the container **must be well mixed** before use.
5. Then shake downwards to make sure the liquid is not in the neck of the container.
6. Hold the bottom tab of the container firmly. Twist and remove the top tab to open it.

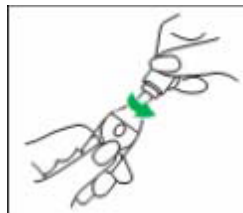

How to put the drops in

Before you put the drops in, you must choose one of the positions shown in these pictures. Although they may not be easy, the positions will make sure the drops get to where they are needed.

1. Gently blow your nose to clear it.

2. While standing up, bend right over.



3. If you can't do this, kneel down and then bend right over.



4. Put the opened container into one nostril and gently squeeze.

5. Keep squeezing until the sides of the container touch each other. This will mean that about half

the dose has been given (about 6 drops).

6. Repeat this step to use the rest in your other nostril.

7. Stay with your head down for at least one minute after putting the drops in.

If these positions are difficult you can lie on a bed with your head tilted over the edge. After you have

put the drops in, rest your head sideways on the bed for at least one minute.



Be careful not to get the drops in your eyes or on broken skin. If you do, rinse your eyes or skin with water immediately.

If you forget to use Flixonase Nasule Drops

If you miss a dose, just use the next dose when it is due. Do not use a double dose to make up for a forgotten dose.